

Ejerlavskode: 1060655
 Opmålingsdistrikt: 10606



KOORDINATLISTE SYSTEM 1934

RTK-tjeneste: Leica SmartNet Danmark

| PKTNR. | Y | X | KV.KL | BEM |
|--------|-----------|-----------|-------|----------------------------|
| 10 | 189840.85 | 256185.83 | 1 | skelafm., J |
| 11 | 189828.12 | 256193.13 | 1 | - |
| 12 | 189811.48 | 256208.24 | 1 | - |
| 13 | 189804.78 | 256218.71 | 1 | - |
| 14 | 189800.68 | 256236.87 | 1 | - |
| 15 | 189799.76 | 256249.01 | 1 | - |
| 16 | 189806.27 | 256260.23 | 1 | - |
| 17 | 189817.06 | 256278.86 | 1 | - |
| 18 | 189851.77 | 256271.07 | 1 | - |
| 19 | 189837.35 | 256255.56 | 1 | - |
| 20 | 189826.86 | 256239.33 | 1 | - |
| 21 | 189833.31 | 256224.58 | 1 | - |
| 22 | 189842.06 | 256213.26 | 1 | - |
| 23 | 189850.97 | 256211.11 | 1 | - |
| 24 | 189858.34 | 256218.36 | 1 | - |
| 25 | 189858.97 | 256234.62 | 1 | - |
| 26 | 189868.69 | 256253.17 | 1 | - |
| 27 | 189873.21 | 256266.39 | 1 | - |
| 28 | 189875.80 | 256271.49 | 1 | - |
| 29 | 189885.82 | 256290.31 | 1 | - |
| 30 | 189876.61 | 256298.53 | 1 | - |
| 31 | 189870.20 | 256298.33 | 1 | - |
| 32 | 189856.27 | 256291.52 | 1 | - |
| 33 | 189853.27 | 256275.86 | 1 | - |
| 34 | 189819.69 | 256283.39 | 1 | - |
| 35 | 189832.50 | 256305.48 | 1 | - |
| 36 | 189839.82 | 256318.10 | 1 | - |
| 37 | 189867.04 | 256314.90 | 1 | - |
| 38 | 189884.59 | 256312.19 | 1 | - |
| 39 | 189910.30 | 256307.43 | 1 | - |
| 40 | 189918.02 | 256289.87 | 1 | - |
| 41 | 189913.12 | 256272.89 | 1 | - |
| 42 | 189911.05 | 256267.81 | 1 | - |
| 43 | 189897.29 | 256244.74 | 1 | - |
| 44 | 189888.36 | 256224.37 | 1 | - |
| 45 | 189880.61 | 256196.91 | 1 | - |
| 46 | 189869.30 | 256186.77 | 1 | - |
| 47 | 189849.82 | 256185.06 | 1 | - |
| 49 | 189779.61 | 256252.14 | 1 | skelafm., gl.B, mellempkt. |
| 50 | 189784.76 | 256212.12 | 1 | skelafm., gl.B |
| 51 | 189799.23 | 256187.20 | 1 | - |
| 52 | 189805.04 | 256295.98 | 1 | skelafm., gl.J |
| 53 | 189823.62 | 256328.06 | 1 | skel gl.mål |
| 54 | 189824.11 | 256328.91 | 1 | skelafm., gl.J, mellempkt. |
| 58 | 189770.63 | 256236.60 | 1 | skelafm., gl.B |
| 59 | 189774.08 | 256242.50 | 1 | skelafm., gl.J |
| 60 | 189807.92 | 256176.11 | 1 | skelafm., J |
| 61 | 189815.92 | 256171.24 | 1 | - |
| 62 | 189826.02 | 256168.33 | 1 | - |
| 63 | 189860.03 | 256164.91 | 1 | - |
| 64 | 189880.75 | 256162.83 | 1 | - |
| 65 | 189891.13 | 256184.29 | 1 | - |
| 66 | 189893.16 | 256206.57 | 1 | - |
| 67 | 189907.50 | 256233.89 | 1 | - |
| 68 | 189929.17 | 256294.49 | 1 | - |
| 69 | 189933.34 | 256315.16 | 1 | - |
| 70 | 189797.58 | 256283.25 | 1 | bygning, sten |
| 71 | 189793.61 | 256276.32 | 1 | - |
| 72 | 189779.13 | 256263.34 | 1 | - |
| 73 | 189797.77 | 256171.17 | 1 | skel gl.mål |

SIGNATUR :

- o B betonskelpæl
- o glB gammel betonskelpæl
- o J jernrør med skeltegn
- o glJ gammelt jernrør med skeltegn
- o i.a målsat skel, ikke afmærket
- © fixpunkt

-  mellempunkt - ret linie
-  lige vinkel
-  ret vinkel

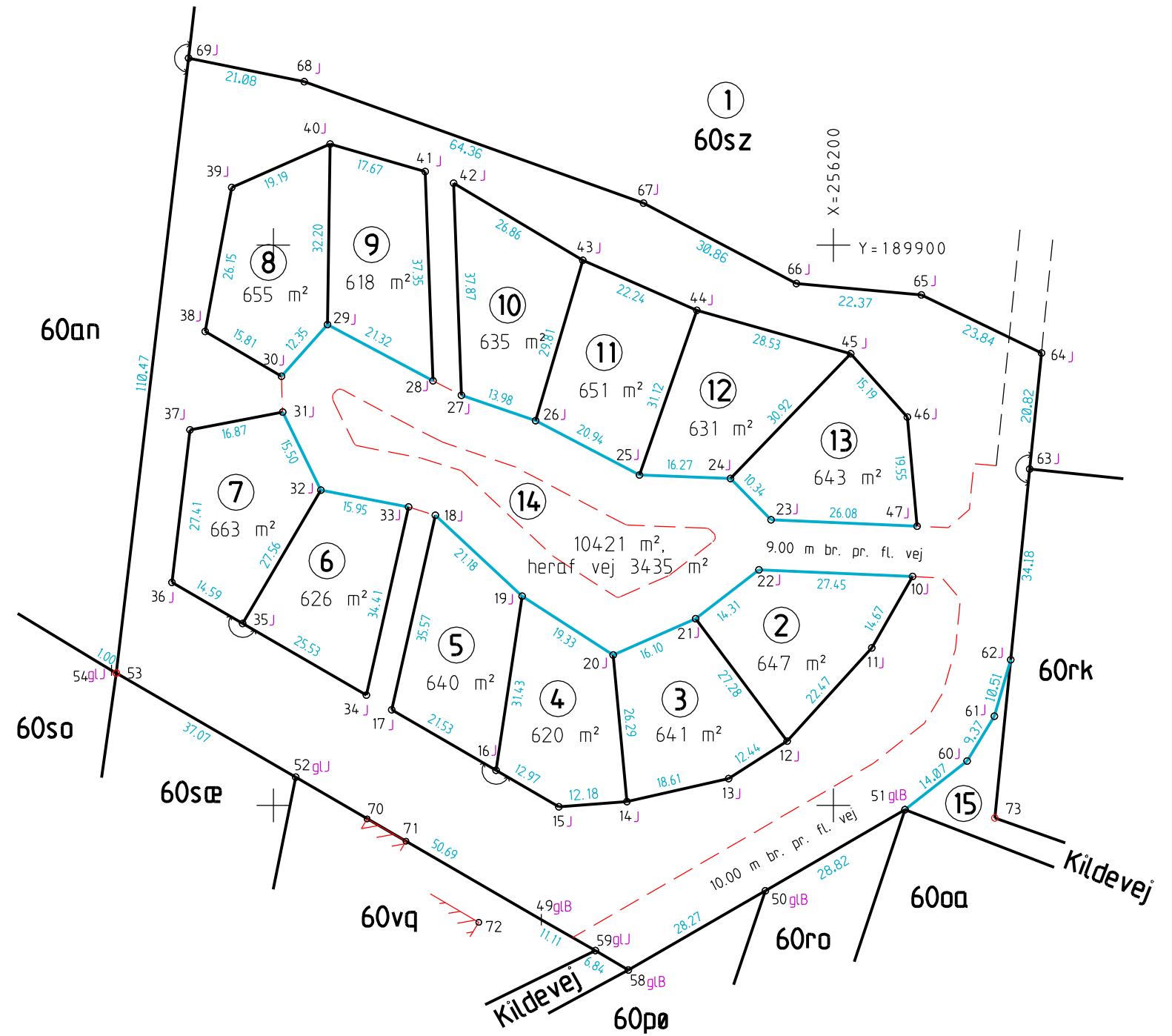

Kildevej 15 - Udstykning

Måleblad i 1:1000 vedr.

matr. nr. 60sz

Linå By, Linå

Silkeborg Kommune, Region Nordjylland

Udfærdiget på grundlag af opmåling, november 2014

Udarb. dato: 12.02.2015/ke

sign: Ole Nørgård
landinspektør

J.NR.: J08214

CAD: j08214 mb v7.dgn



Fredericiavej 16
7100 Vejle

tlf. 75 82 32 66

www.geopartner.dk